

UCFL2

Unit No.	Shaft Dia.		Dimensions (mm) (inch)									Bolt Used (mm) (in.)	Bearing No.	Housing No.	Weight (kg) (lb)
	d		H	J	L	A ₂	A ₁	A	N	E	S				
	(in.)	(mm)													
UCFL201	12	98	76	56	15	11	25.5	10	33.3	12.7	M8	UC201	FL203	0.54	
201-8	1/2	3.8583	3	2.2047	0.5906	0.4331	1.0039	0.3906	1.3110	0.5000	5/16	201-8		1.2	
UCFL202	15	98	76	56	15	11	25.5	10	33.3	12.7	M8	UC202	FL203	0.54	
202-9	9/16	3.8583	3	2.2047	0.5906	0.4331	1.0039	0.3906	1.3110	0.5000	5/16	202-9		1.2	
202-10	5/8	3.8583	3	2.2047	0.5906	0.4331	1.0039	0.3906	1.3110	0.5000	5/16	202-10		1.2	
UCFL203	17	98	76	56	15	11	25.5	10	33.3	12.7	M8	UC203	FL203	0.54	
203-11	11/16	3.8583	3	2.2047	0.5906	0.4331	1.0039	0.3906	1.3110	0.5000	5/16	203-11		1.2	
UCFL204	20	113	90	60	15	11	25.5	10	33.3	12.7	M8	UC204	FL204	0.52	
204-12	3/4	4.4488	3.5433	2.3622	0.5906	0.4331	1.0039	0.3906	1.3110	0.5000	5/16	204-12		1.1	
UCFL205	25	130	99	68	16	13	27	12	35.8	14.3	M10	UC205	FL205	0.64	
205-14	7/8	5.1181	3.8976	2.6772	0.6299	0.5118	1.0630	0.4724	1.4094	0.5630	3/8	205-14		1.4	
205-15	15/16	5.1181	3.8976	2.6772	0.6299	0.5118	1.0630	0.4724	1.4094	0.5630	3/8	205-15		1.4	
205-16	1	5.1181	3.8976	2.6772	0.6299	0.5118	1.0630	0.4724	1.4094	0.5630	3/8	205-16		1.4	
UCFL206	30	148	117	80	18	13	31	12	40.2	15.9	M10	UC206	FL206	0.93	
206-17	1 1/16	5.8268	4.6063	3.1496	0.7087	0.5118	1.2205	0.4724	1.5827	0.6260	3/8	206-17		2.0	
206-18	1 1/8	5.8268	4.6063	3.1496	0.7087	0.5118	1.2205	0.4724	1.5827	0.6260	3/8	206-18		2.0	
206-19	1 3/16	5.8268	4.6063	3.1496	0.7087	0.5118	1.2205	0.4724	1.5827	0.6260	3/8	206-19		2.0	
206-20	1 1/4	5.8268	4.6063	3.1496	0.7087	0.5118	1.2205	0.4724	1.5827	0.6260	3/8	206-20		2.0	
UCFL207	35	161	130	90	19	15	34	13.1	44.4	17.5	M10	UC207	FL207	1.20	
207-20	1 1/4	6.3386	5.1181	3.5433	0.7480	0.5906	1.3386	0.5156	1.7480	0.6890	7/16	207-20		2.6	
207-21	1 5/16	6.3386	5.1181	3.5433	0.7480	0.5906	1.3386	0.5156	1.7480	0.6890	7/16	207-21		2.6	
207-22	1 3/8	6.3386	5.1181	3.5433	0.7480	0.5906	1.3386	0.5156	1.7480	0.6890	7/16	207-22		2.6	
207-23	1 7/16	6.3386	5.1181	3.5433	0.7480	0.5906	1.3386	0.5156	1.7480	0.6890	7/16	207-23		2.6	
UCFL208	40	175	144	100	21	15	36	13.1	51.2	19.0	M12	UC208	FL208	1.59	
208-24	1 1/2	6.8898	5.6693	3.9370	0.8268	0.5906	1.4173	0.5156	2.0157	0.7480	1/2	208-24		3.5	
208-25	1 9/16	6.8898	5.6693	3.9370	0.8268	0.5906	1.4173	0.5156	2.0157	0.7480	1/2	208-25		3.5	
UCFL209	45	188	148	108	22	16	38	15	52.2	19.0	M14	UC209	FL209	1.84	
209-26	1 5/8	7.4016	5.8268	4.2520	0.8661	0.6299	1.4961	0.5937	2.0551	0.7480	9/16	209-26		4.1	
209-27	1 11/16	7.4016	5.8268	4.2520	0.8661	0.6299	1.4961	0.5937	2.0551	0.7480	9/16	209-27		4.1	
209-28	1 3/4	7.4016	5.8268	4.2520	0.8661	0.6299	1.4961	0.5937	2.0551	0.7480	9/16	209-28		4.1	
UCFL210	50	197	157	115	22	16	40	15	54.6	19.0	M14	UC210	FL210	2.15	
210-30	1 7/8	7.7559	6.1811	4.5276	0.8661	0.6299	1.5748	0.5937	2.1496	0.7480	9/16	210-30		4.7	
210-31	1 15/16	7.7559	6.1811	4.5276	0.8661	0.6299	1.5748	0.5937	2.1496	0.7480	9/16	210-31		4.7	
210-32	2	7.7559	6.1811	4.5276	0.8661	0.6299	1.5748	0.5937	2.1496	0.7480	9/16	210-32		4.7	

Alternative dimensions are available, for critical engineering or construction requirements please confirm these dimensions with your local Ringball branch

Two-bolt flange units

setscrew locking

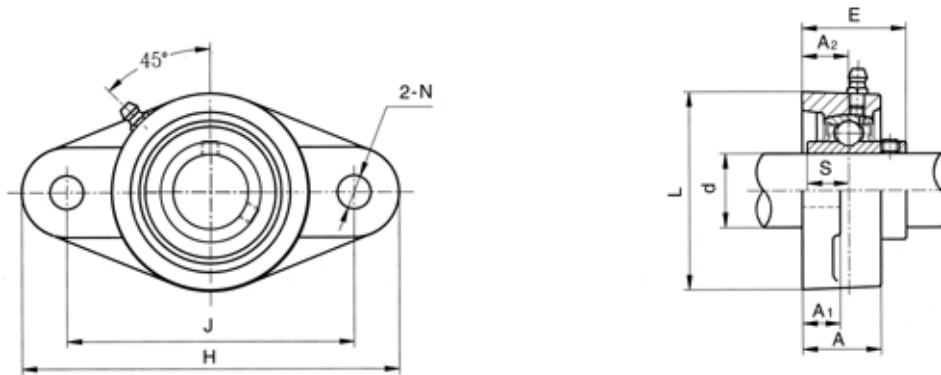

UCFL2

Unit No.	Shaft Dia.		Dimensions (mm) (inch)									Bolt Used (mm) (in.)	Bearing No.	Housing No.	Weight (kg) (lb)
	d		H	J	L	A ₂	A ₁	A	N	E	S				
	(in.)	(mm)													
UCFL 211		55	224	184	130	25	18	43	16.2	58.4	22.2	M14	UC211	FL211	3.10
211-32	2												211-32		
211-34	2 1/8		8.8189	7.2441	5.1181	0.9842	0.7087	1.6929	0.6406	2.2992	0.8740	9/16	211-34		6.8
211-35	2 3/16												211-35		
UCFL 212		60	250	202	140	29	18	48	16.2	68.7	25.4	M14	UC212	FL212	3.99
212-36	2 1/4												212-36		
212-37	2 5/16		9.8425	7.9528	5.5118	1.1417	0.7087	1.8898	0.6406	2.7047	1.0000	9/16	212-37		8.8
212-38	2 3/8												212-38		
212-39	2 7/16												212-39		
UCFL 213		65	258	210	155	30	22	50	16.2	69.7	25.4	M14	UC213	FL213	4.96
213-40	2 1/2		10.157	8.2677	6.1024	1.1811	0.8661	1.9685	0.6406	2.7441	1.0000	9/16	213-40		10.9
UCFL 214		70	265	216	160	31	22	54	16.2	75.4	30.2	M14	UC214	FL214	5.60
214-43	2 1/16		10.433	8.5039	6.2992	1.2205	0.8661	2.1260	0.6406	2.9685	1.1890	9/16	214-43		12.3
214-44	2 3/4												214-44		
UCFL 215		75	275	225	165	34	22	56	19	78.5	33.3	M16	UC215	FL215	6.21
215-46	2 7/8		10.827	8.8583	6.4961	1.3386	0.8661	2.2047	0.7480	3.0906	1.3110	5/8	215-46		13.7
215-47	2 15/16												215-47		
215-48	3												215-48		

Alternative dimensions are available, for critical engineering or construction requirements please confirm these dimensions with your local Ringball branch