

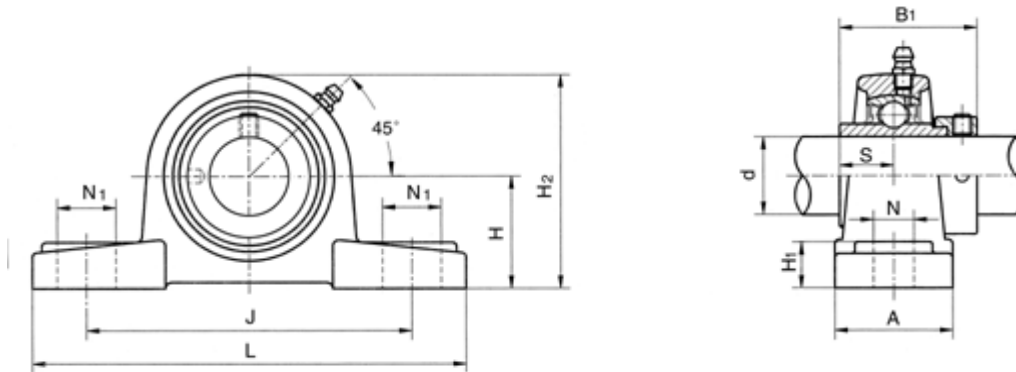

Pillow block units
eccentric collar locking



NAP2

Unit No.	Shaft Dia.		Dimensions (mm) (inch)										Bolt Used (mm) (in.)	Bearing No.	Housing No.	Weight (kg) (lb)
	d		H	L	J	A	N	N ₁	H ₁	H ₂	S	B ₁				
	(in.)	(mm)														
NAP201 201-8	1/2	12	30.2 1.1890	127 5.0000	95 3.7402	38 1.4961	13 0.5118	19 0.7480	14 0.5512	60 2.3622	17.0 0.6693	43.5 1.7126	M10 3/8	NA201 201-8	P203	0.80 1.9
NAP202 202-9 202-10	9/16 5/8	15	30.2 1.1890	127 5.0000	95 3.7402	38 1.4961	13 0.5118	19 0.7480	14 0.5512	60 2.3622	17.0 0.6693	43.5 1.7126	M10 3/8	NA202 202-9 202-10	P203	0.80 1.9
NAP203 203-11	11/16	17	30.2 1.1890	127 5.0000	95 3.7402	38 1.961	13 0.5118	19 0.7480	14 0.5512	60 2.3622	17.0 0.6693	43.5 1.7126	M10 3/8	NA203 203-11	P203	0.80 1.9
NAP204 204-12	3/4	20	33.3 1.3110	127 5.0000	95 3.7402	38 1.4961	13 0.5118	19 0.7480	14 0.5512	65 2.5590	17.0 0.6693	43.5 1.7126	M10 3/8	NA204 204-12	P204	0.79 1.7
NAP205 205-14 205-15 205-16	7/8 15/16 1	25	36.5 1.4370	140 5.5118	105 4.1338	38 1.4961	13 0.5118	19 0.7480	15 0.5906	71 2.7953	17.4 0.6850	44.3 1.7441	M10 3/8	NA205 205-14 205-15 205-16	P205	0.95 2.1
NAP206 206-17 206-18 206-19 206-20	1 1/16 1 1/8 1 3/16 1 1/4	30	42.9 1.6890	165 6.4961	121 4.7638	48 1.8898	17 0.6693	21 0.8268	17 0.6693	83 3.2677	18.2 0.7165	48.3 1.9016	M14 9/16	NA206 206-17 206-18 206-19 206-20	P206	1.41 3.1
NAP207 207-20 207-21 207-22 207-23	1 1/4 1 5/16 1 3/8 1 7/16	35	47.6 1.8740	167 6.5748	127 5.0000	48 1.8898	17 0.6693	21 0.8268	18 0.7087	93 3.6614	18.8 0.7402	51.1 2.0118	M14 9/16	NA207 207-20 207-21 207-22 207-23	P207	1.85 4.1
NAP208 208-24 208-25	1 1/2 1 9/16	40	49.2 1.9370	184 7.2441	137 5.3937	54 2.1260	17 0.6693	21 0.8268	18 0.7087	98 3.8583	21.4 0.8425	56.3 2.2165	M14 9/16	NA208 208-24 208-25	P208	2.28 5.0
NAP209 209-26 209-27 209-28	1 5/8 1 11/16 1 3/4	45	54 2.1260	190 7.4803	146 5.7480	54 2.1260	17 0.6693	21 0.8268	20 0.7874	106 4.1732	21.4 0.8425	56.3 2.2165	M14 9/16	NA209 209-26 209-27 209-28	P209	2.62 5.8
NAP210 210-30 210-31 210-32	1 7/8 1 15/16 2	50	57.2 2.2520	206 8.1102	159 6.2598	60 2.3622	20 0.7874	25 0.9842	21 0.8268	114 4.4882	24.6 0.9685	62.7 2.4685	M16 5/8	NA210 210-30 210-31 210-32	P210	3.30 7.3

Alternative dimensions are available, for critical engineering or construction requirements please confirm these dimensions with your local Ringball branch

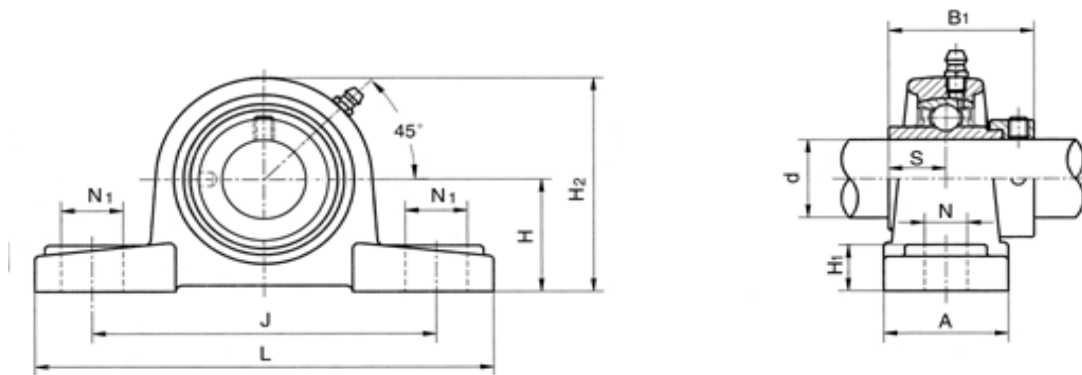

NAP 2

Unit No.	Shaft Dia.		Dimensions (mm) (inch)										Bolt Used (mm) (in.)	Bearing No.	Housing No.	Weight (kg) (lb)
	d		H	L	J	A	N	N ₁	H ₁	H ₂	S	B ₁				
	(in.)	(mm)														
NAP211		55	63.5	219	171	60	20	25	23	126	27.7	71.4	M16	NA 211	P211	4.12
211-32	2													211-32		
211-34	2 1/8		2.5000	8.6220	6.7323	2.3622	0.7874	0.9842	0.9055	4.9606	1.0906	2.8110	5/8	211-34		9.1
211-35	2 3/16													211-35		
NAP212		60	69.8	241	184	70	20	25	25	138	30.9	77.8	M16	NA 212	P212	5.43
212-36	2 1/4													212-36		
212-37	2 5/16		2.7480	9.4882	7.2441	2.7559	0.7874	0.9842	0.9842	5.4331	1.2165	3.0630	5/8	212-37		12.0
212-38	2 3/8													212-38		
212-39	2 7/16													212-39		
NAP213		65	76.2	264	203	70	25	30	27	151	34.1	85.7	M20	NA 213	P213	6.81
213-40	2 1/2		3.0000	10.394	7.9921	2.7559	0.9842	1.1811	1.0630	5.9449	1.3425	3.3740	3/4	213-40		15.0
NAP214		70	79.4	266	210	72	25	30	27	157	34.1	85.7	M20	NA 214	P214	7.42
214-43	2 1/16		3.1260	10.472	8.2677	2.8346	0.9842	1.1811	1.0630	6.1811	1.3425	3.3740	3/4	214-43		16.3
214-44	2 3/4													214-44		
NAP215		75	82.6	275	217	74	25	30	28	163	37.3	92.1	M20	NA 215	P215	8.25
215-46	2 7/8		3.2520	10.827	8.5433	2.9134	0.9842	1.1811	1.1024	6.4173	1.4685	3.6260	3/4	215-46		18.2
215-47	2 15/16													215-47		
215-48	3													215-48		

Alternative dimensions are available, for critical engineering or construction requirements please confirm these dimensions with your local Ringball branch