

## Single Groove Sheaves for "3L"

**Table No. 1 Stock Sizes-Finished Bore**

Part No.	DIAMETER		Type	STOCK BORES MARKED "X"					DIMENSIONS				Wt.
	Outside	Pitch "3L"		3/8"	1/2"	5/8"	3/4"	1"	F	L	P	C	
OK12	1.42"	1.25"	1F	X	X	-	-	-	1/2"	1/2"	-	-	0.1
OK15	1.67	1.50	1F	X	X	X	-	-	1/2	1/2	-	-	0.1
OK17	1.92	1.75	1F	-	X	X	X	-	1/2	1/2	-	-	0.3
OK20	2.17	2.00	1F	-	X	X	X	-	1/2	1/2	-	-	0.4
OK22	2.40	2.25	1F	-	X	X	X	-	1/2	1/2	-	-	0.5
OK25	2.67	2.50	1F	-	X	X	X	-	1/2	1/2	-	-	0.05
OK30	3.17	3.00	2	-	X	X	X	-	9/16	1 1/32	15/32"	0	1.0
OK35	3.67	3.50	2	-	X	X	X	-	9/16	1 1/32	15/32	0	1.0
OK40	4.17	4.00	3	-	X	X	X	X	9/16	1 1/32	15/32	0	0.9
OK45	4.67	4.50	3	-	X	X	X	X	9/16	1 1/32	15/32	0	1.3
OK50	5.17	5.00	3	-	X	X	X	X	9/16	1 1/32	15/32	0	1.6
OK60	6.17	6.00	3	-	X	X	X	X	9/16	1 1/32	15/32	0	1.8
OK70	7.17	7.00	3	-	X	X	X	X	9/16	1 1/32	15/32	0	2.3
OK80	8.17	8.00	3	-	X	X	X	-	5/8	1 1/16	7/16	0	2.8
OK90	9.17	9.00	3	-	X	X	X	-	5/8	1 1/16	7/16	0	3.0
OK100	10.17	10.00	3	-	-	X	X	-	5/8	1 1/16	7/16	0	3.8

Type 1F sheaves are machined from bar steel.

Types 2 and 3 are machined from cast iron. All have hollow head setscrews and standard keyseats.

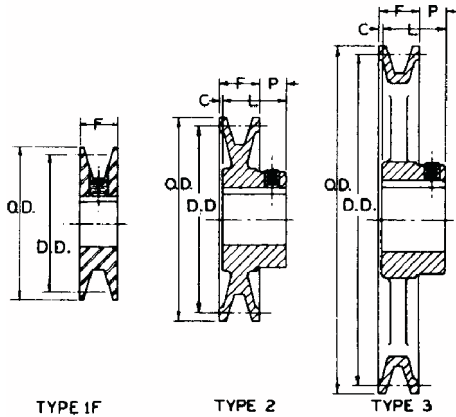

### AL Standard Keyseats

Table No. 3

Bore Range	Keyseat
3/8" to 1/2"	None
5/8 to 7/8	3/16"x3/32"
1 5/16 to 1 1/8	1/4x1/8

**Table No. 1 Stock "OL", "AL" and "AM" Sheaves**

Part No.	DIAMETER		STOCK BORES MARKED "X"			DIMENSIONS				Wt. Lbs.
	Outside	Pitch	5/8"	3/4"	1"	F	L	P	C	
★OL50	4.93"	4.80"	X	X	-	19/32	1 1/16"	15/32"	-	1.1
★OL60	5.93	5.80	X	X	-	19/32	1 1/16	15/32	-	1.4
★OL70	6.93	6.80	X	-	-	19/32	1 1/16	15/32	-	1.5
AL54	4.93	4.78	X	X	X	19/32	1 1/16	15/32	-	1.1
AL64	5.93	5.78	X	X	X	19/32	1 1/16	15/32	-	1.2
AL74	6.93	6.78	X	X	X	19/32	1 1/16	15/32	-	1.5
AL84	7.93	7.78	X	X	X	19/32	1 1/16	15/32	-	1.8
AL94	8.93	8.78	-	X	X	19/32	1 1/16	15/32	-	2.4
AL104	9.93	9.78	-	X	X	19/32	1 1/16	15/32	-	2.9
AL114	10.93	10.78	-	X	X	19/32	1 1/16	15/32	-	3.1
AL124	11.93	11.78	-	X	X	19/32	1 1/16	15/32	-	3.8
AM144	14.16	14.00	-	-	X	11/16	1 3/4	13/32	1/32"	5.2

★ For use with "3L" Belts; Other sizes for use with "4L" or "A"

Stock "OL", "AL" and "AM" Sheaves are equipped with Hollow Head Set Screws and have no Keyseat.

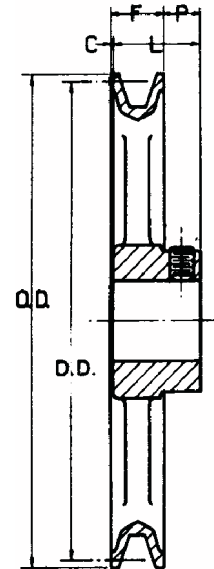



### Two Groove Variable Pitch Sheaves for "3L", "4L", "5L", "A", "B" or "5V" Belts

**Table No. 1 Stock Sizes-Finished Bore (Inches)**

Part No.	Typ	DIAMETER RANGE																Stock Bores Marked "x"								
		"3L" BELTS				"4L" or "A" BELTS				"5L" OR "B" BELTS				'5V'				1/2	5/8	3/4	7/8	1	1 1/8	1 1/4	1 3/8	1 5/8
		Min. Pitch	Turns Open	Max Pitch	Turns Open	Min. Pitch	Turns Open	Max Pitch	Turns Open	Min. Pitch	Turns Open	Max Pitch	Turns Open	Min. Pitch	Turns Open	Turns Pitch	Turns Open									
2VP36	4	1.9	4	2.7	0	2	5	3.0	0	2.5	5	3.3	1	-	-	-	-	x	x	x	x	-	-	-	-	-
2VP42	4	2.5	4	3.3	0	2.6	5	3.6	0	2.9	6	3.9	1	-	-	-	-	-	x	x	x	x	x	-	-	-
2VP50	5	3.3	4	4.1	0	3.4	5	4.4	0	3.7	6	4.7	1	-	-	-	-	-	x	x	x	x	x	-	-	-
2VP56	5	3.9	4	4.7	0	4	5	5.0	0	4.3	6	5.3	1	-	-	-	-	-	x	x	x	x	x	-	-	-
2VP60	5	-	-	-	-	4.2	5	5.2	0	4.3	6	5.5	0	-	-	-	-	-	-	x	x	-	x	-	x	x
2VP62	5	4.5	4	5.3	0	4.6	5	5.6	0	4.9	6	5.9	1	5.3	6	6.3	1	-	-	x	x	x	x	x	-	-
2VP65	5	-	-	-	-	4.7	5	5.7	0	4.8	6	6.0	0	5.2	6	6.4	0	-	-	x	x	-	x	-	x	x
2VP68	5	5.1	4	5.9	0	5.2	5	6.2	0	5.5	6	6.5	1	5.9	6	6.9	1	-	-	-	x	x	x	x	-	-
2VP71	5	-	-	-	-	5.3	5	6.3	0	5.4	6	6.6	0	5.8	6	7.0	0	-	-	x	x	-	x	-	x	x
2VP75	5	-	-	-	-	5.7	5	6.7	0	5.8	6	7.0	0	6.2	6	7.4	0	-	-	x	x	-	x	-	x	x

All fitted with Hollow Head Setscrews.

**Table No.2 Dimensions (Inches)**

Part No.	Typ	DIMENSIONS(Inches)							Wt. Lbs
		O.D	F		G		L	K	
			Max	Min.	Max	Min.			
2VP36	4	3.35	2	1 3/8	13/16	1/2	3	1 3/16	3.4
2VP42	4	3.95	2 1/8	1 3/8	7/8	1/2	3	1 3/16	4.4
2VP50	5	4.75	2 1/8	1 3/8	7/8	1/2	3	1 3/16	6.3
2VP56	5	5.35	2 1/8	1 3/8	7/8	1/2	3	1 3/16	7.8
2VP60	5	6.00	2 3/8	1 5/8	1 1/32	21/32	3 1/4	1 1/4	10.6
2VP62	5	5.95	2 1/8	1 3/8	7/8	1/2	3	1 3/16	10
2VP65	5	6.50	2 3/8	1 5/8	1 1/32	21/32	3 1/4	1 1/4	12.3
2VP68	5	6.55	2 1/8	1 3/8	7/8	1/2	3	1 3/16	11.7
2VP71	5	7.10	2 3/8	1 5/8	1 1/32	21/32	3 1/4	1 1/4	14.6
2VP75	5	7.50	2 3/8	1 5/8	1 1/32	21/32	3 1/4	1 1/4	16.5

**Table No.3 Standard Keyseat**

Bore Range	Keyseat
1/2	None
5/8-7/8	3/16x3/32
1-1 1/4	1/4x1/8
1 3/8	5/16x5/32

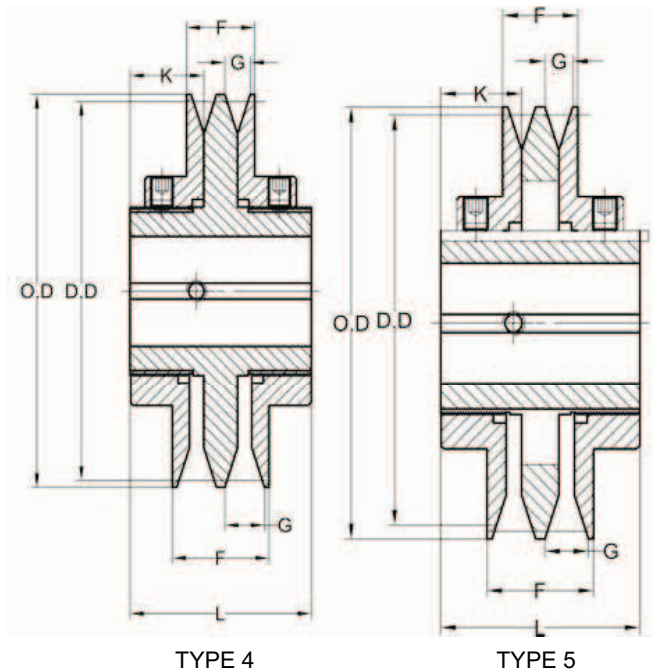

### Stock "VL" and "VM" Variable Pitch Sheaves

Table No. 1

Part No.	DIAMETER RANGE												Stock Bores Marked "x"				
	"3L" BELTS				"4L" or "A" BELTS				"5L" or "B" BELTS				1/2	5/8	3/4	7/8	
	Min. Pitch	Turns Open	Max Pitch	Turns Open	Min. Dat	Turns Open	Max Pitch	Turns Open	Min. Pitch	Turns Open	Max Pitch	Turns Open					
1VL25	1.6	4	2.4	0	-	-	-	-	-	-	-	-	-	x	x	-	-
1VL30	1.8	4	2.7	0	-	-	-	-	-	-	-	-	-	x	x	-	-
1VL34	1.7	4	2.5	0	1.9	5	2.9	0	2.4	5	3.2	1	1	x	x	x	-
1VL40	2.3	4	3.1	0	2.4	5	3.4	0	2.7	6	3.7	1	1	x	x	x	x
1VL44	2.7	4	3.5	0	2.8	5	3.8	0	3.1	6	4.1	1	1	x	x	x	x
1VM50	3.3	4	4.1	0	3.4	5	4.4	0	3.7	6	4.7	1	1	x	x	x	x

Table No. 2 Dimensions

Part No.	DIMENSIONS							
	O.D.	F		G		L	K	Wt. Lbs
		Max.	Min.	Max.	Min.			
1VL25	2.50	25/32	17/32	5/8	3/8	1 1/2	37/64	.8
1VL30	2.87	25/32	17/32	5/8	3/8	1 1/2	37/64	1.0
1VL34	3.15	1	5/8	7/8	1/2	1 11/16	37/64	1.1
1VL40	3.75	1	5/8	7/8	1/2	1 11/16	37/64	1.3
1VL44	4.15	1	5/8	7/8	1/2	1 11/16	37/64	1.3
1VM50	4.75	1 1/16	11/16	7/8	1/2	1 7/8	21/32	2.8

**"VL", "VM" Sheaves are machined. Both are furnished with Standard Keyseats and Hollow Head Setscrews.**

#### Standard Keyseats

Bore Range	Keyseat
1/2	none
5/8-7/8	3/16x3/32

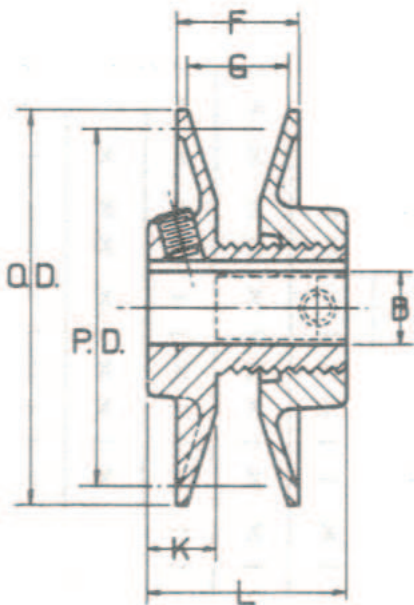

1VL25-1VL44

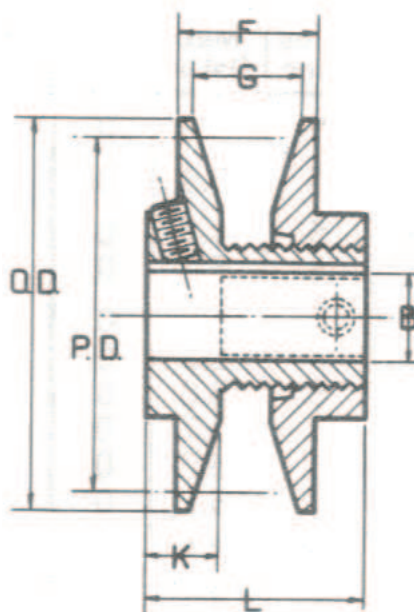

1VM50

